



INSTALLATION DRAWING

ACO Polycrete Pty Ltd
1300 765 226
sales@acoaus.com.au

DRG #: IN001
www.acobuildline.com.au
www.acobuildline.co.nz

SLOTCHANNEL, SUSPENDED SLAB, VINYL FLOORING

ACO Limited
0800 448 080
sales@aconz.co.nz

SlotChannel

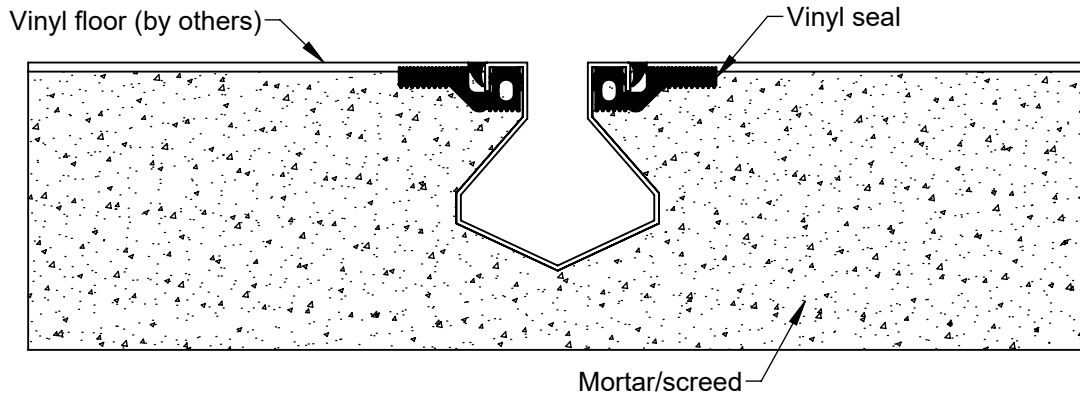

Outlet Unit

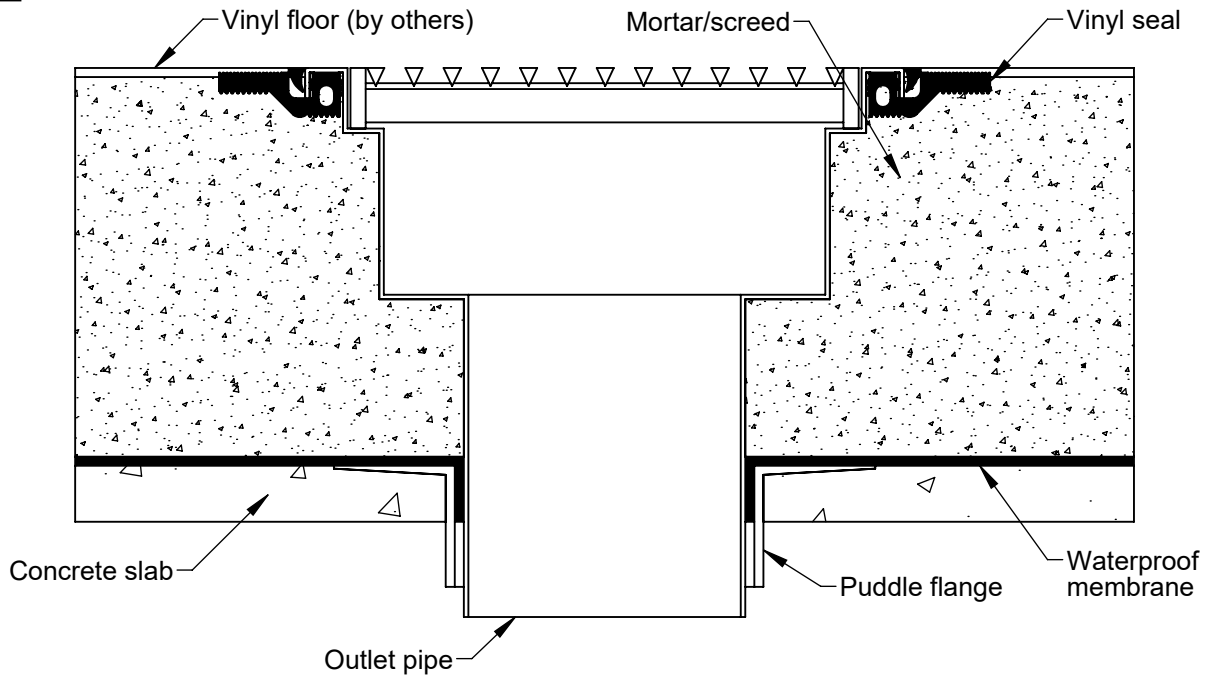

NOTES:

1.. These details only provide a practical reference. ACO recommends designers and installers check local legislative standards and practices, or seek specialised engineering advice.

Specification Clause

The floor channels are to be ACO Stainless SlotChannel grade **304/316** stainless steel as supplied by ACO Polycrete Pty Ltd. All components used within the scope of the systems are shown on Drawing Number/s: _____*.

All work should be carried out strictly in accordance with the manufacturer's instructions and the installation details set out on Drawing Number/s: _____*.

All components are to be supplied with constant depth channels with vinyl edge to suit vinyl flooring. The channels shall have a continuous slot of 20mm and overall depth and length, position, nominal size of outlet as specified on Drawing Number/s: _____*.

Grates for outlet unit are to be part number _____*.

**Please delete or complete where appropriate*